

Tool Series 371: HSC Carbide End Mills for Soft Materials - Regular Length

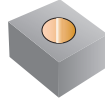

Tolerance (Uncoated):	
D1=D2:	h5
D1<D2:	h6
D2:	h5

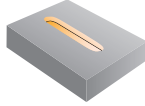
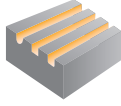
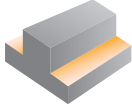
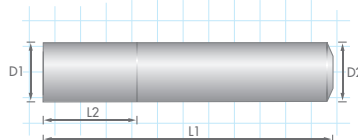
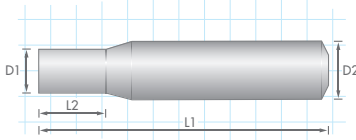

Uncoated Tool Number	Coated Tool Number	D1	D2	L1	L2	Z
371-2010	371-2010-P	1	4	50	3	2
371-2020	371-2020-P	2	4	50	6	2
371-2030	371-2030-P	3	6	50	10	2
371-2040	371-2040-P	4	6	50	15	2
371-2050	371-2050-P	5	6	50	20	2
371-2060	371-2060-P	6	6	50	20	2
371-3060	371-3060-P	6	6	50	20	3
371-2080	371-2080-P	8	8	63	25	2
371-3080	371-3080-P	8	8	63	25	3
371-2100	371-2100-P	10	10	75	25	2
371-3100	371-3100-P	10	10	75	25	3
371-2120	371-2120-P	12	12	75	30	2
371-3120	371-3120-P	12	12	75	30	3
371-2140	371-2140-P	14	14	75	30	2
371-3140	371-3140-P	14	14	75	30	3
371-2160	371-2160-P	16	16	89	35	2
371-3160	371-3160-P	16	16	89	35	3
371-2180	371-2180-P	18	18	89	45	2
371-3180	371-3180-P	18	18	89	45	3
371-2200	371-2200-P	20	20	100	45	2
371-3200	371-3200-P	20	20	100	45	3

