

Tool Series 392: HPC Finishing Carbide End Mills for Steels & High Temp. Alloys

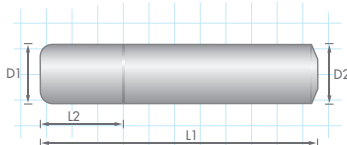

Tolerance:	
D1:	h8
D2:	h5

Uncoated Tool Number	Coated Tool Number	D1	D2	L1	L2	CR	Z
392-5030-02	392-5030-02-R	3	6	50	10	0.2	5
392-5040-02	392-5040-02-R	4	6	50	15	0.2	5
392-5040-05	392-5040-05-R	4	6	50	15	0.5	5
392-5050-02	392-5050-02-R	5	6	50	20	0.2	5
392-5050-05	392-5050-05-R	5	6	50	20	0.5	5
392-5060-02	392-5060-02-R	6	6	50	20	0.2	5
392-5060-05	392-5060-05-R	6	6	50	20	0.5	5
392-5080-03	392-5080-03-R	8	8	63	25	0.3	5
392-5080-05	392-5080-05-R	8	8	63	25	0.5	5
392-5080-10	392-5080-10-R	8	8	63	25	1	5
392-5100-05	392-5100-05-R	10	10	75	25	0.5	5
392-5100-10	392-5100-10-R	10	10	75	25	1	5
392-5100-20	392-5100-20-R	10	10	75	25	2	5
392-5120-05	392-5120-05-R	12	12	75	30	0.5	5
392-5120-10	392-5120-10-R	12	12	75	30	1	5
392-5120-20	392-5120-20-R	12	12	75	30	2	5
392-5140-05	392-5140-05-R	14	14	75	30	0.5	5
392-5140-10	392-5140-10-R	14	14	75	30	1	5
392-5140-20	392-5140-20-R	14	14	75	30	2	5
392-5160-10	392-5160-10-R	16	16	89	35	1	5
392-5160-20	392-5160-20-R	16	16	89	35	2	5
392-5180-10	392-5180-10-R	18	18	89	45	1	5
392-5180-20	392-5180-20-R	18	18	89	45	2	5
392-5200-10	392-5200-10-R	20	20	100	45	1	5
392-5200-20	392-5200-20-R	20	20	100	45	2	5

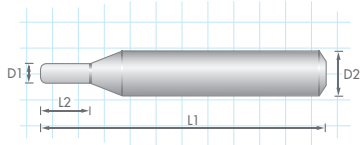
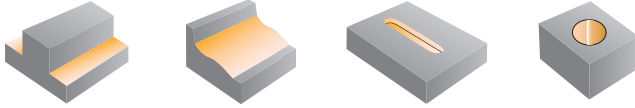